



LOAD-MASTER

Load Monitoring • Force Measurement • Industrial Weighing

LOAD-MASTER LM Tension Load Cell

- Rated capacities from 5tonne to 300tonne
- Cabled (LM-C) and Wireless (LM-W) versions
- Lightweight high strength aluminium alloy load cell

LOAD-MASTER LM tension link load cells are used in a huge variety of testing and suspended load measurement applications, including: **load indicators** for proof load testing of lifting machinery; **force gauges** for line tension measurement; **crane scales** for overhead weighing.

Designed to accept industry standard lifting grade shackles, with high safety factor and environmental protection, LOAD-MASTER LM load cells guarantee safe and accurate measurements in all industrial processes.

LM-C and LM-W standard portable systems include handset display with 'tare' and 'peak hold' function.

Also available with a range of single and multi-channel indicating, recording & control instruments.

Capacity	Divisions	A	B	C	D	ØE	Shackle Size
5	0.001	250	95	35	170	27	6.5 *
12	0.005	290	101	48	180	40	12 *
25	0.01	320	127	55	200	55	25 *
50	0.01	430	152	75	250	76	55 *
100	0.1	600	265	100	320	100	120 **
200	0.1	700	325	150	350	146	200 **
300	0.2	800	375	180	420	162	300 **
tonne				mm			tonne

* Suggested suitable shackle: Van Beest Green Pin G-4163

** Suggested suitable shackle: Van Beest Green Pin G-6036

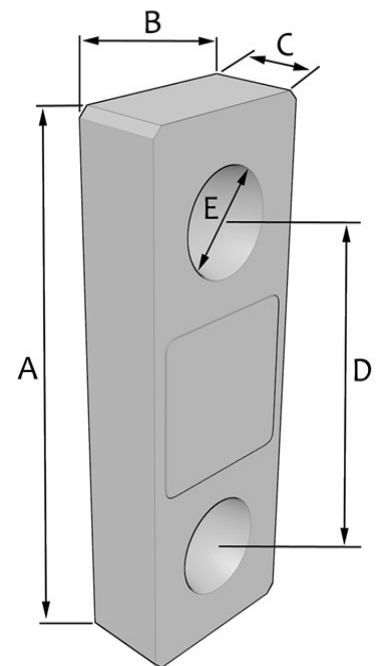

Display Units	tonne
Battery life	250 hours minimum
Wireless Range (LM-W)	100 metre (direct sight)
Cable Length (LM-C)	10 metre
Maximum Error	0.25 % applied load
Safety Factor	5 x rated capacity
Operating Temperature	0 to 50 °C
Environmental Sealing	IP65

Force
LOGIC UK

Manufactured in the UK 

Specifications subject to change. Full product details available on request.

LMDS_3.0

Force Logic UK Ltd N4 Lambs Farm Business Park, Swallowfield, RG7 1PQ, UK

(+44) 0118 988 8807 sales@force-logic.co.uk www.force-logic.co.uk